

Timing Pulleys

METRIC
2.5 mm pitch



Associated Products
Shafts

All dimensions in mm
General tolerances +/- 0.13mm
Material: Free machining
aluminium alloy pulley
Zinc plated steel flanges

When belt width = 6, W=10 & L=16

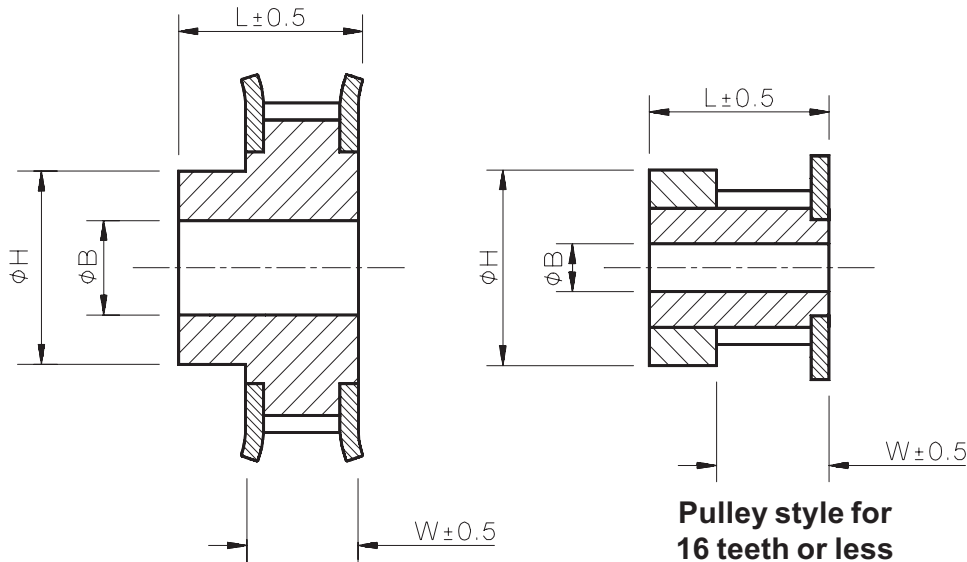

Operates with TXM25 series timing belts (page 2).

Part Number Selection Table						
Example Part No. - TPMP25 F6- 60						
Basic Part Number	Belt Width	No. of teeth	Pitch Diameter	Bore ϕB (H7)	Hub Diameter $\phi H \pm 1.0$	Backlash
TPMP25	6mm F6-	12	9.55	3	12	$\pm 0.08\text{mm}$
		14	11.14	3	14	
		15	11.94	3	15	
		18	14.32	4	10	
		19	15.12	4	10	
		20	15.92	4	12	
		24	19.10	4	14	$\pm 0.15\text{mm}$
		25	19.89	4	14	
		30	23.87	6	16	
		32	25.46	6	16	
		36	28.65	6	20	
		40	31.83	6	22	
		48	38.20	6	26	
		60	47.75	8	34	

Pulleys with 48 and 60 teeth are unflanged.

Additional options

- zero backlash pulleys
- 0, 1 or 2 flanges
- modified bore diameters
- other numbers of teeth
- tapped holes in hubs
- keyed bores

Standard Product Sales : ☎ +44 (0)1484 601060 📠 +44 (0)1484 601061

www.rpmechatronics.co.uk

sales@rpmechatronics.co.uk

© Reliance Precision Mechatronics LLP