

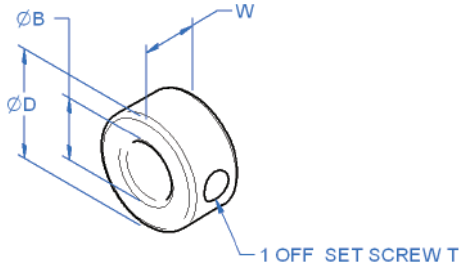

One-Piece Set Screw Collars

4-10mm Bore



MSC (set screw)

General Information

All dimensions in mm
 Manufactured by
 Ruland Corp
 Material:
 Aluminium alloy
 grade 2024.T351
 Stainless steel
 grade 18.8 type 303

Associated Products

Shafts
 Bearings
 Leadscrews

Visit our online
 catalogue for
 associated products

Part number selection table

Example Part No:- MSC-A-4			Dimensions (mm)			
Basic Part No.	Material	Size	Standard Bore Sizes ØB (bore tolerance +0.01/+0.05)	O/D ØD	Width W	Forged Set Screw T
MSC	A (Aluminium)	4	4	8	5	M2.5x3
		5	5	10	6	M3X4
	SS (St. Steel)	6	6	12	8	M4X4
		8	8	16	8	M4X4
		10	10	20	10	M5X5

Non-standard options, please enquire....

- Non-standard bore sizes, including imperial.
- Stainless steel screws.
- Plastic collars available.

Technical features

- Forged socket set screw.
- Width tolerances: +0.08mm/-0.25mm.

