



# Solid Couplings

3-10mm Bore

## General Information

All dimensions in mm  
 Manufactured by  
 Ruland Corp  
 Material:  
 Aluminium alloy  
 grade 2024.T351  
 Stainless steel  
 grade 18.8 type 303

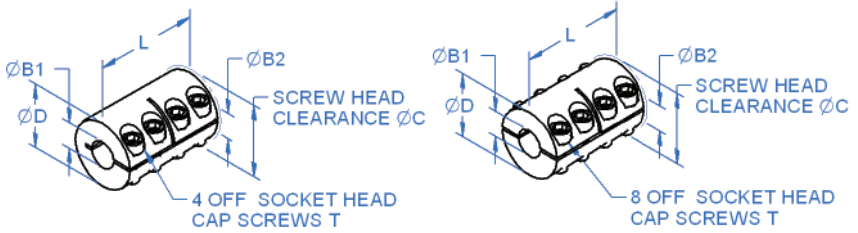

MCLX (1-piece)

MSPX (2-piece)

## Associated Products

Shafts  
 Bearings  
 Leadscrews

Visit our online catalogue for associated products

## Part number selection table

Example Part No:- MCLX-A-3-3			Dimensions (mm)				
Basic Part No.	Material	Size	Standard Bore Sizes ØB1 and ØB2 (bore tolerance +0.05/-0.00)	O/D		Length L	Forged Clamp Screw T
				ØD	ØC		
MCLX (1-piece)	A (Aluminium)	3	3	15	22	15.0	M2
		4	4	15	22	15.0	M2
		5	5	15	22	15.0	M2
MSPX (2-piece)	SS* (St. Steel)	6	6	18	30	21.5	M3
		8	8	24	35	27.1	M3
		10	10	29	45	33.0	M4

Imperial bores (1/8" to 3/8") available, please enquire.

\*Stainless steel is only available on MSPX

## Non-standard options, please enquire....

- Non-standard bore sizes, including imperial.
- Set screw clamping.
- Stainless steel screws.

## Technical features

- Does not mark the shaft.
- Nypatch® Anti-vibration hardware.
- Precision honed bore.
- MSPX, two-piece style is balanced by opposing hardware and is easily disassembled and maintained.
- Max speed: 3,000 RPM.

