



Pin Hub Spur Gear

6 - 12mm Bore

General Information

All dimensions in mm
General tolerances:
±0.13mm

Material:
Stainless steel
or
Aluminium alloy

Pressure angle 20°

SKT. HD. SET
SCREW S
SUPPLIED

SUB-DRILLED ØP

ØB

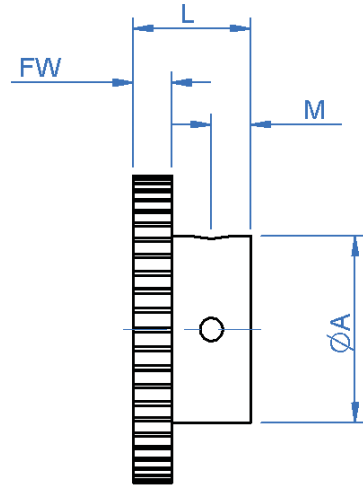

Associated Products

Anti-backlash gears
Shafts
Bearings
Gear clamps

Visit our online
catalogue for
associated products

Drawing dimension table

| Bore Size Nom | Bore Dia ØB | Overall Length L | Gear Face Width FW | Boss Dia ØA | Hole Position M | Set Screw S | Sub-Drill ØP |
|---------------|-------------|------------------|--------------------|-------------|-----------------|-------------|--------------|
| 6 | 6.003 | 9 | 3 | 12.00 | 3.20 2.80 | M3 | 1.6 |
| | 5.995 | 10 | 4 | | | | |
| | | 12 | 6 | | | | |
| 8 | 8.003 | 10 | 4 | 16.00 | | M4 | 2.0 |
| | 7.995 | 12 | 6 | | | | |
| 10 | 10.003 | 12 | 4 | 19.00 | 4.20 3.80 | M5 | 2.4 |
| | 9.995 | 14 | 6 | | | | |
| 12 | 12.003 | 20 | 8 | 24.00 | 6.20 5.80 | M6 | |
| | 11.995 | 24 | 12 | | | | |

- Standard gear quality AQ10 - see page 56.
- Material and treatment specifications - see page 59.

Non-standard options, please enquire....

- Higher gear qualities - see page 56.
- Alternative modules.
- Imperial diametral pitches.
- Imperial bore sizes 1/4", 5/16", 3/8" & 1/2".

www.rpmechatronics.co.uk

Standard Product Sales : ☎ +44 (0)1484 601060 📠 +44 (0)1484 601061
www.rpmechatronics.co.uk sales@rpmechatronics.co.uk

© Reliance Precision Mechatronics LLP

6 - 12mm Bore

Pin Hub Spur Gear



Part number selection table

Example Part No:- **P06S1B8 F4A- 32**

| Bore Size Nom | Standard Modules | Basic Part Number Standard Materials | | Face Width | Number of Teeth | |
|---------------|------------------|--------------------------------------|-----------------|--------------|-----------------|-----|
| | | Stainless Steel | Aluminium Alloy | Dim FW | Min | Max |
| 6 | 0.6 | P06S1B6 | P06A1B6 | F3A- (3mm) | 23 | 127 |
| | 0.5 | P05S1B6 | P05A1B6 | | 27 | 152 |
| | 0.4 | P04S1B6 | P04A1B6 | F4A- (4mm) | 33 | 190 |
| | 0.3 | P03S1B6 | P03A1B6 | | 43 | 254 |
| | 0.25 | P025S1B6 | P025A1B6 | F6A- (6mm) | 50 | 304 |
| | 0.2 | P02S1B6 | P02A1B6 | | 62 | 381 |
| 8 | 0.6 | P06S1B8 | P06A1B8 | F4A- (4mm) | 30 | 127 |
| | 0.5 | P05S1B8 | P05A1B8 | | 35 | 152 |
| | 0.4 | P04S1B8 | P04A1B8 | F6A- (6mm) | 43 | 190 |
| | 0.3 | P03S1B8 | P03A1B8 | | 56 | 254 |
| | 0.25 | P025S1B8 | P025A1B8 | F6A- (6mm) | 66 | 304 |
| | 0.2 | P02S1B8 | P02A1B8 | | 82 | 381 |
| 10 | 0.6 | P06S1B10 | P06A1B10 | F4A- (4mm) | 34 | 127 |
| | 0.5 | P05S1B10 | P05A1B10 | | 40 | 152 |
| | 0.4 | P04S1B10 | P04A1B10 | F6A- (6mm) | 50 | 190 |
| | 0.3 | P03S1B10 | P03A1B10 | | 65 | 254 |
| | 0.25 | P025S1B10 | P025A1B10 | F6A- (6mm) | 77 | 304 |
| | 0.2 | P02S1B10 | P02A1B10 | | 95 | 381 |
| 12 | 0.6 | P06S1B12 | P06A1B12 | F8A- (8mm) | 41 | 127 |
| | 0.5 | P05S1B12 | P05A1B12 | | 48 | 152 |
| | 0.4 | P04S1B12 | P04A1B12 | F12A- (12mm) | 59 | 190 |
| | 0.3 | P03S1B12 | P03A1B12 | | 77 | 254 |
| | 0.25 | P025S1B12 | P025A1B12 | F12A- (12mm) | 92 | 304 |
| | 0.2 | P02S1B12 | P02A1B12 | | 113 | 381 |

General Information

All dimensions in mm
 General tolerances: ±0.13mm
 Material:
 Stainless steel or Aluminium alloy
 Pressure angle 20°

Associated Products

Anti-backlash gears
 Shafts
 Bearings
 Gear clamps
 Visit our online catalogue for associated products

www.rpmechatronics.co.uk

