



Hubless Spur Gear

5 - 25mm Bore

General Information

All dimensions in mm
General tolerances:

±0.13mm

Material:

Stainless steel
or
Aluminium alloy

Pressure angle 20°

Associated Products

Anti-backlash gears

Shafts

Gear and dial hubs

Visit our online catalogue for associated products

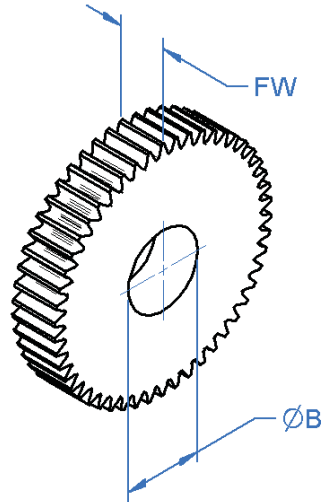

Drawing dimension table

Bore Size Nom	Bore Dia ØB	Gear Face Width FW
5	5.003	3
	4.995	6
10	10.003	3
	9.995	6
15	15.003	3
	14.995	6
25	25.003	3
	24.995	6

- Standard gear quality AQ10 - see page 56.
- Material and treatment specifications - see page 59.

Non-standard options, please enquire....

- Higher gear qualities - see page 56.
- Alternative modules.
- Alternative bore sizes.
- Imperial diametral pitches.
- Imperial bore sizes 3/16", 3/8", 11/16" & 1".

www.rpmechatronics.co.uk

Standard Product Sales : ☎ +44 (0)1484 601060 📠 +44 (0)1484 601061
www.rpmechatronics.co.uk sales@rpmechatronics.co.uk

© Reliance Precision Mechatronics LLP



Part number selection table

Example Part No:- **F06S1B10 F6A- 50**

Bore Size Nom	Standard Modules	Basic Part Number Standard Materials		Face Width	Number of Teeth	
		Stainless Steel	Aluminium Alloy	Dim FW	Min	Max
5	0.6	F06S1B5	F06A1B5	F3A- (3mm) or F6A- (6mm)	19	127
	0.5	F05S1B5	F05A1B5		20	152
	0.4	F04S1B5	F04A1B5		23	190
	0.3	F03S1B5	F03A1B5		27	254
	0.25	F025S1B5	F025A1B5		30	304
	0.2	F02S1B5	F02A1B5		35	381
10	0.6	F06S1B10	F06A1B10	F3A- (3mm) or F6A- (6mm)	27	127
	0.5	F05S1B10	F05A1B10		30	152
	0.4	F04S1B10	F04A1B10		35	190
	0.3	F03S1B10	F03A1B10		44	254
	0.25	F025S1B10	F025A1B10		50	304
	0.2	F02S1B10	F02A1B10		60	381
15	0.6	F06S1B15	F06A1B15	F3A- (3mm) or F6A- (6mm)	35	127
	0.5	F05S1B15	F05A1B15		40	152
	0.4	F04S1B15	F04A1B15		48	190
	0.3	F03S1B15	F03A1B15		60	254
	0.25	F025S1B15	F025A1B15		70	304
	0.2	F02S1B15	F02A1B15		85	381
25	0.6	F06S1B25	F06A1B25	F3A- (3mm) or F6A- (6mm)	52	127
	0.5	F05S1B25	F05A1B25		60	152
	0.4	F04S1B25	F04A1B25		73	190
	0.3	F03S1B25	F03A1B25		94	254
	0.25	F025S1B25	F025A1B25		110	304
	0.2	F02S1B25	F02A1B25		135	381

General Information

All dimensions in mm
 General tolerances: ±0.13mm
 Material:
 Stainless steel or Aluminium alloy
 Pressure angle 20°

Associated Products

Anti-backlash gears
 Shafts
 Gear and dial hubs
 Visit our online catalogue for associated products

www.rpmechatronics.co.uk

