



Anti-backlash Synchro Gears

4.76mm Bore

General Information

All dimensions in mm
 General tolerances:
 ±0.13mm
 Material:
 Stainless steel
 or
 Aluminium alloy
 Pressure angle 20°

Associated Products

Spur gears

Visit our online catalogue for associated products

www.rpmechatronics.co.uk

FITTING PIN
TO BE REMOVED
AFTER MESHING

TWO HOLES TO
SUIT LUGS ON
DRIVE WASHER

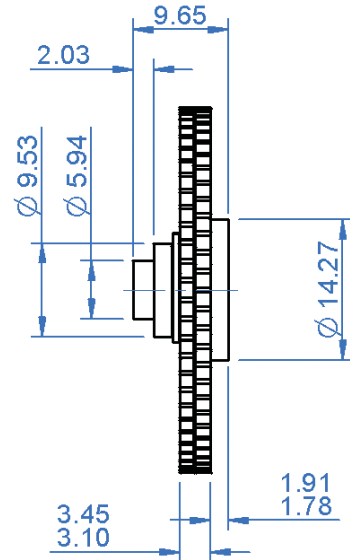
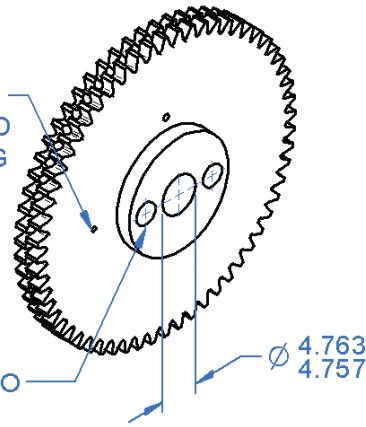

Part number selection table

Example Part No:- **AS06S1B4.7F33A- 60**

Bore Size	Standard Modules	Basic Part Number Standard Materials		Number of Teeth	
		Stainless Steel	Aluminium Alloy	Min	Max
4.76	0.6	AS06S1B4.7F33A-	AS06A1B4.7F33A-	30	102
	0.5	AS05S1B4.7F33A-	AS05A1B4.7F33A-	36	123
	0.4	AS04S1B4.7F33A-	AS04A1B4.7F33A-	44	154
	0.3	AS03S1B4.7F33A-	AS03A1B4.7F33A-	57	207
	0.25	AS025S1B4.7F33A-	AS025A1B4.7F33A-	68	248
	0.2	AS02S1B4.7F33A-	AS02A1B4.7F33A-	84	311

- Standard gear quality AQ10 - see page 56.
- To suit size 11, 15, & 18 synchros.
- Material and treatment specifications - see page 59.

Non-standard options, please enquire....

- Higher gear qualities - see page 56.
- Alternative modules.
- Imperial diametral pitches.
- Imperial bore size 0.187".

Standard Product Sales : ☎ +44 (0)1484 601060 📠 +44 (0)1484 601061
 www.rpmechatronics.co.uk sales@rpmechatronics.co.uk

© Reliance Precision Mechatronics LLP