



### Twin Ball Bearing Journal for Coupling, End D

Refer to page 16 for ordering instructions and available associated product part numbers.

#### General Information

All dimensions in mm  
General tolerances:  
 $\pm 0.13\text{mm}$

#### Associated Products

Visit our online catalogue for associated products at:

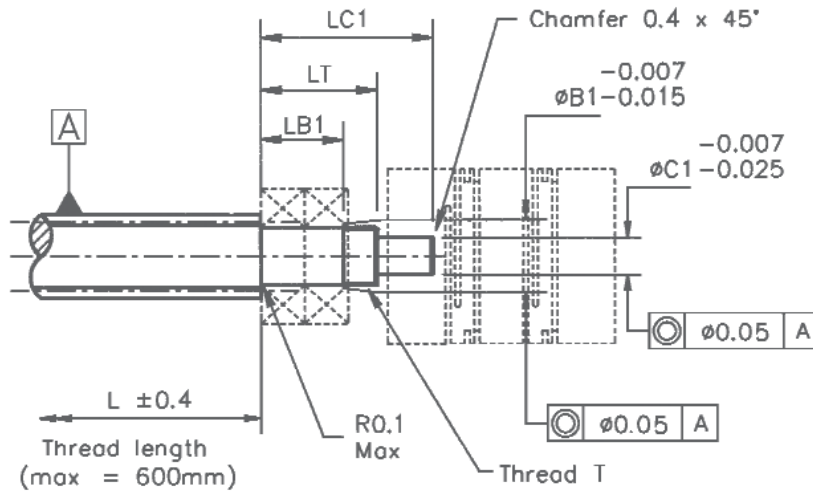

Drawing dimension table

Leadscrew Series	Screw Dia	Journal		Thread		Coupling	
		Dia $\text{ØB1}$	Length LB1	Distance LT	T	Dia $\text{ØC1}$	Length LC1
LAF6, LPX6	6.35	4	7.5	11.2	M4	3	17.5
LAF10, LAK10, LPX10	9.53	6	9.5	15.0	M6	4	22.5
LAF11, LPX11	11.11	8	11.5	18.5	M8	6	28.5
LAF13, LAX13, LPX13	12.70	8	11.5	18.5	M8	6	28.5

www.rpmechatronics.co.uk

- End modification engineered to maximise the linear accuracy of the leadscrew.
- Custom end machining also available, please fax or e-mail your drawing.
- Full technical support available on both standard and custom end machining.
- Quantities up to 10 off available in 2 weeks.



Standard Product Sales : ☎ +44 (0)1484 601060 📠 +44 (0)1484 601061  
www.rpmechatronics.co.uk sales@rpmechatronics.co.uk

© Reliance Precision Mechatronics LLP