

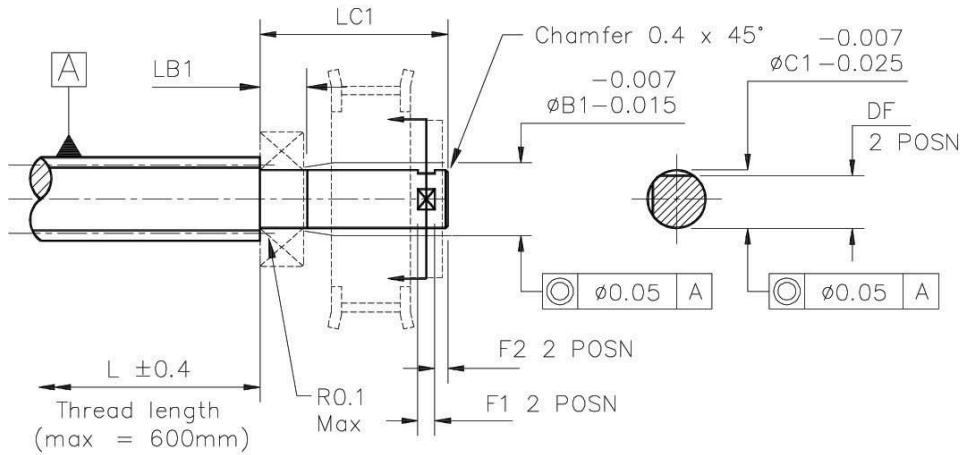

Ball Bearing Journal for Drive Pulley, End E

Refer to page 16 for ordering instructions and available associated product part numbers.



General Information

All dimensions in mm
General tolerances:
±0.13mm

Associated Products

Visit our online catalogue for associated products at:

Drawing dimension table

Leadscrew Series	Screw Dia	Journal		Pulley Dia ØC1	Length LC1	Flats		
		Dia ØB1	Length LB1			Width F1	Length F2	Distance DF
LAF6, LPX6	6.35	4	4.5	4	27.5	4	3	3.5
LAF10, LAK10, LPX10	9.53	6	5.5	6	28.5	5	3	5.5
LAF11, LPX11	11.11	8	6.5	8	29.5	6	3	7.5
LAF13, LAX13, LPX13	12.70	8	6.5	8	29.5	6	3	7.5

www.rpmechatronics.co.uk

- End modification engineered to maximise the linear accuracy of the leadscrew.
- Custom end machining also available, please fax or e-mail your drawing.
- Full technical support available on both standard and custom end machining.
- Quantities up to 10 off available in 2 weeks.

