



Rack Actuator - Size 11

Typical Applications

General Information

All dimensions in mm
General tolerances:
±0.13mm

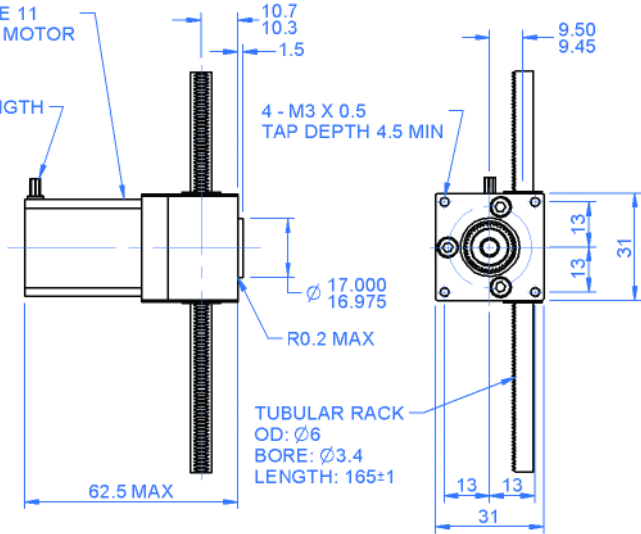

Notes

* Please refer to note on page 11.

Part number selection table

Part Number	Rack Length	Rack Dia	Axial Load
RRA11-6-165	165 ±1	6	3N

Technical specification*

- Standard drive: NEMA size 11 stepper motor (catalogue part No. RSM11N1E2).
- Tubular rack: 6mm OD, 3.4mm bore, 165mm length, 316 stainless steel.
- Travel range: 130mm.
- Max continuous axial load: 3N.
- Max momentary load: 12N.
- Max speed: 300mm/sec.
- Resolution: 0.21mm with 200 steps/rev.
0.0033mm with microstepping (12800 steps/rev).
- Temperature range: -20°C to +50°C.
- Repeatability: 0.025mm.
- Life: in excess of 5 million cycles.
- Side wobble, fully extended: ±0.2mm.
- Backlash: equivalent to less than 0.08mm linear movement.
- No lubricant required.
- Smooth quiet operation - no metal to metal contact.